

similar to DIN 69 882-8, type G

Rev. 12-1101 Page 1 of 1
Uncontrolled Document

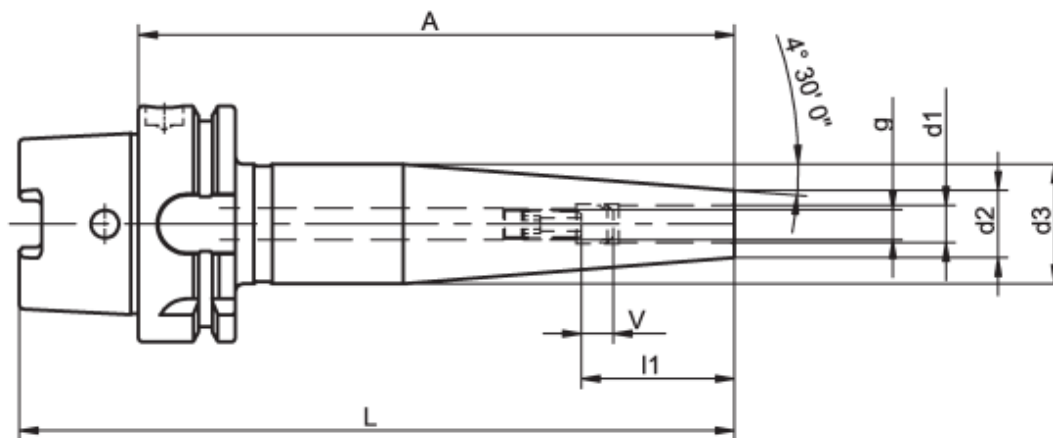

Design

Permissible concentricity deviation of hollow taper shank to location hole $d_1 = 0.003$ mm (measured at $3 \times D$ cantilever length). Chucks are fine balanced according to ISO 1940-1 G 2.5 at 25,000 rpm. The clamping diameter is designed for a shank tolerance of h6.

Note

Slim design with an outer chamfer of $2^\circ 30'$. Other designs and sizes are available on request.

Available for HSK-E 40